

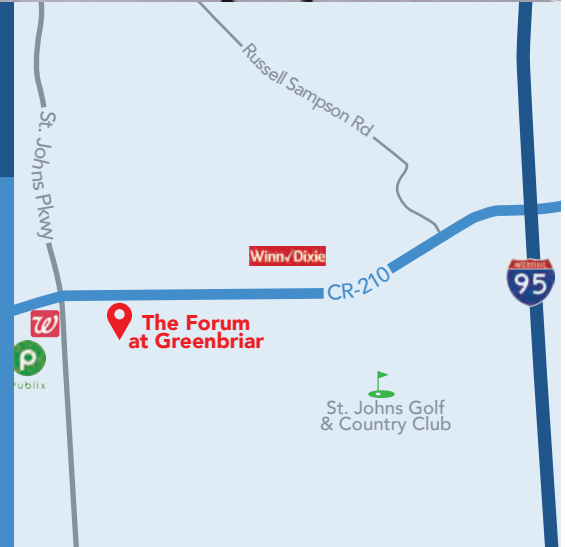

THE FORUM AT GREENBRIAR

2703 County Rd 210 | St. Augustine, FL 32092

- The Forum at Greenbriar is an 81,000 sf shopping center including a 57,000 sf± multi-story office/retail building
- Strategically positioned within 5 miles of an affluent trade area with household incomes exceeding \$130k
- Location also includes a 3,000 sf± built-to-suit pad



SIZE

Total
56,000 sf±

Divisible Space
1,000-7,000 sf±

Contiguous Space
26,000 sf±

DEMOGRAPHICS

	<u>Population</u>	<u>Total Households</u>	<u>Average HH Income</u>
1 Mi	4,366	1,517	\$133,175
3 Mi	21,326	7,121	\$133,078
5 Mi	52,057	18,388	\$126,817

TRAFFIC

County Rd 210
34,000

St. Johns Pkwy
9,900

SITE MAP

The Forum at Greenbriar | 2703 CR 210 | St. Augustine, FL 32092

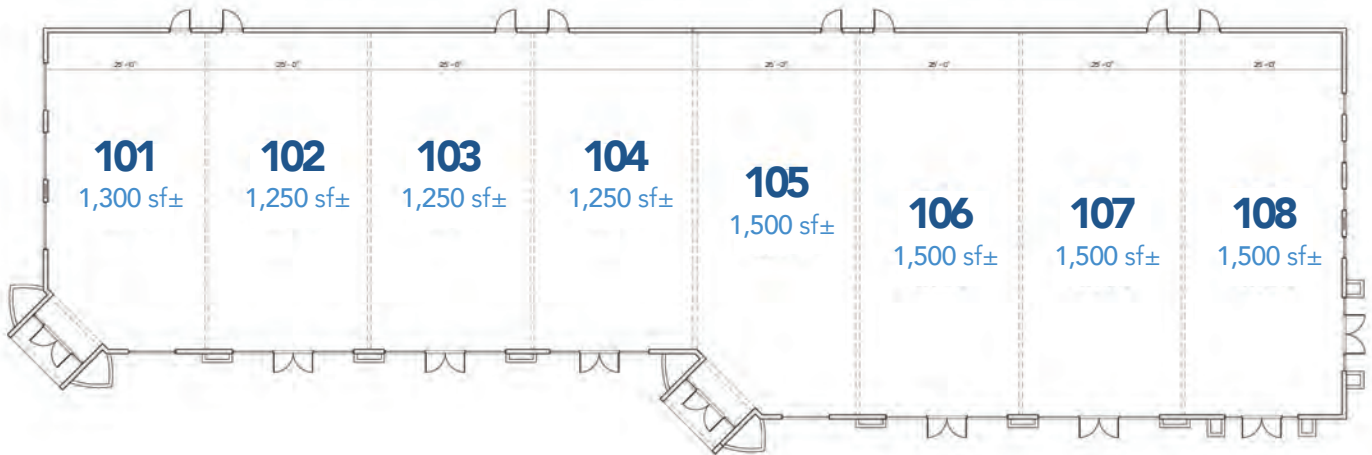

104 Ashourian Ave

FOR MORE INFO [ashproperties.com](https://www.ashproperties.com) leasing@ashproperties.com 904.992.9000

SITE MAP

The Forum at Greenbriar | 2703 CR 210 | St. Augustine, FL 32092

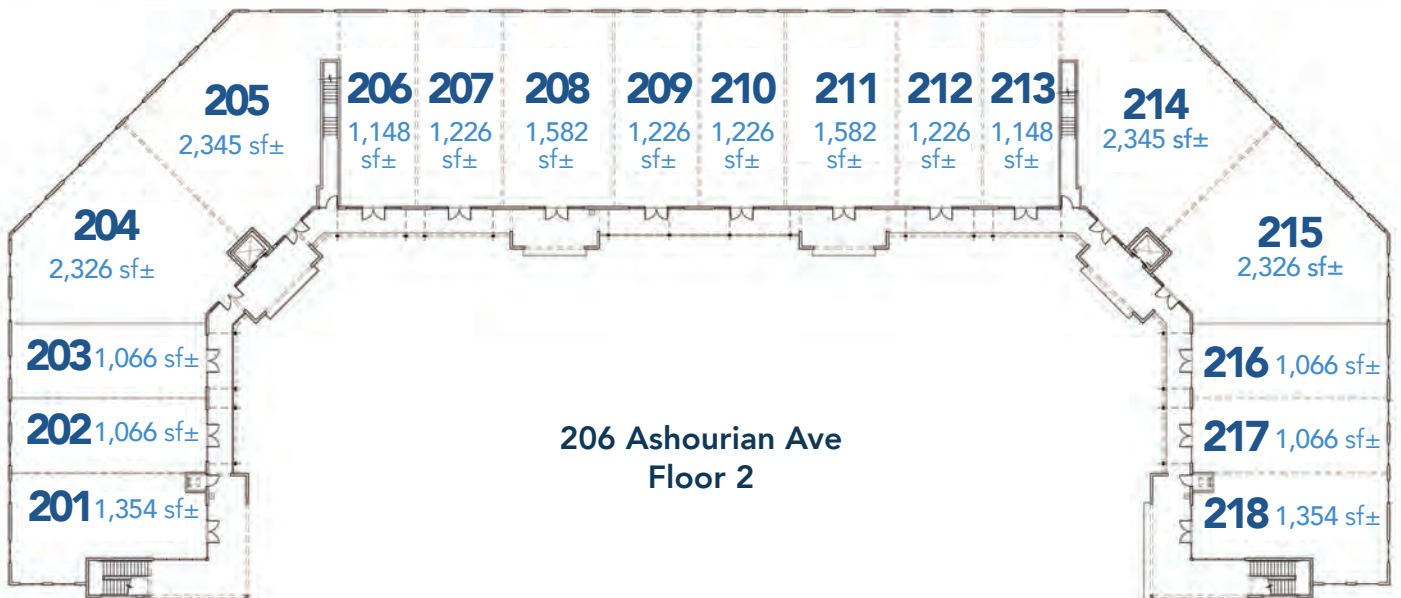

SITE MAP

The Forum at Greenbriar | 2703 CR 210 | St. Augustine, FL 32092

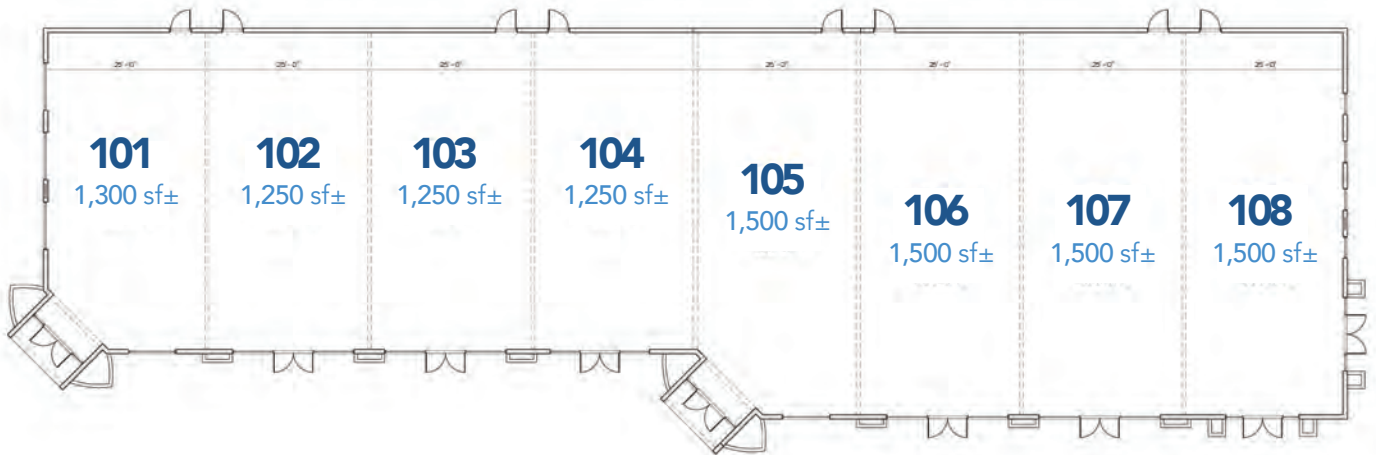

304 Ashourian Ave

PHOTOS

The Forum at Greenbriar | 2703 CR 210 | St. Augustine, FL 32092



FOR MORE INFO  [ashproperties.com](https://www.ashproperties.com)  leasing@ashproperties.com  904.992.9000