

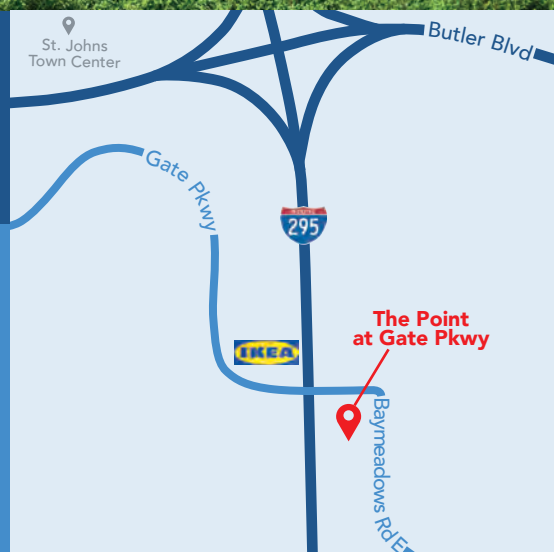

THE POINT at GATE PKWY

7720 Baymeadows Rd E | Jacksonville, FL 32256

- ♦ Strategically positioned in the heart of Jacksonville's booming Southside market
- ♦ Top two floors present a variety of office spaces fit for modern professionals
- ♦ Ground floor units ideal for retail shopping



SIZE

Building Size

54,354 sf±

Divisible Space

Retail:

1,000-7,500 sf±

Office:

2,000-30,000 sf±



DEMOGRAPHICS

Population

1 Mi **3,903**

3 Mi **43,690**

5 Mi **127,647**

Total
Households

1,026

9,925

30,298

Average
HH Income

\$114,568

\$96,995

\$91,257



TRAFFIC

Baymeadows Rd

15,300

I-295/SR-9A

105,000

PHOTOS

The Point at Gate Parkway | 7720 Baymeadows Rd E | Jacksonville, FL 32256



1ST FLOOR

The Point at Gate Parkway | 7720 Baymeadows Rd E | Jacksonville, FL 32256

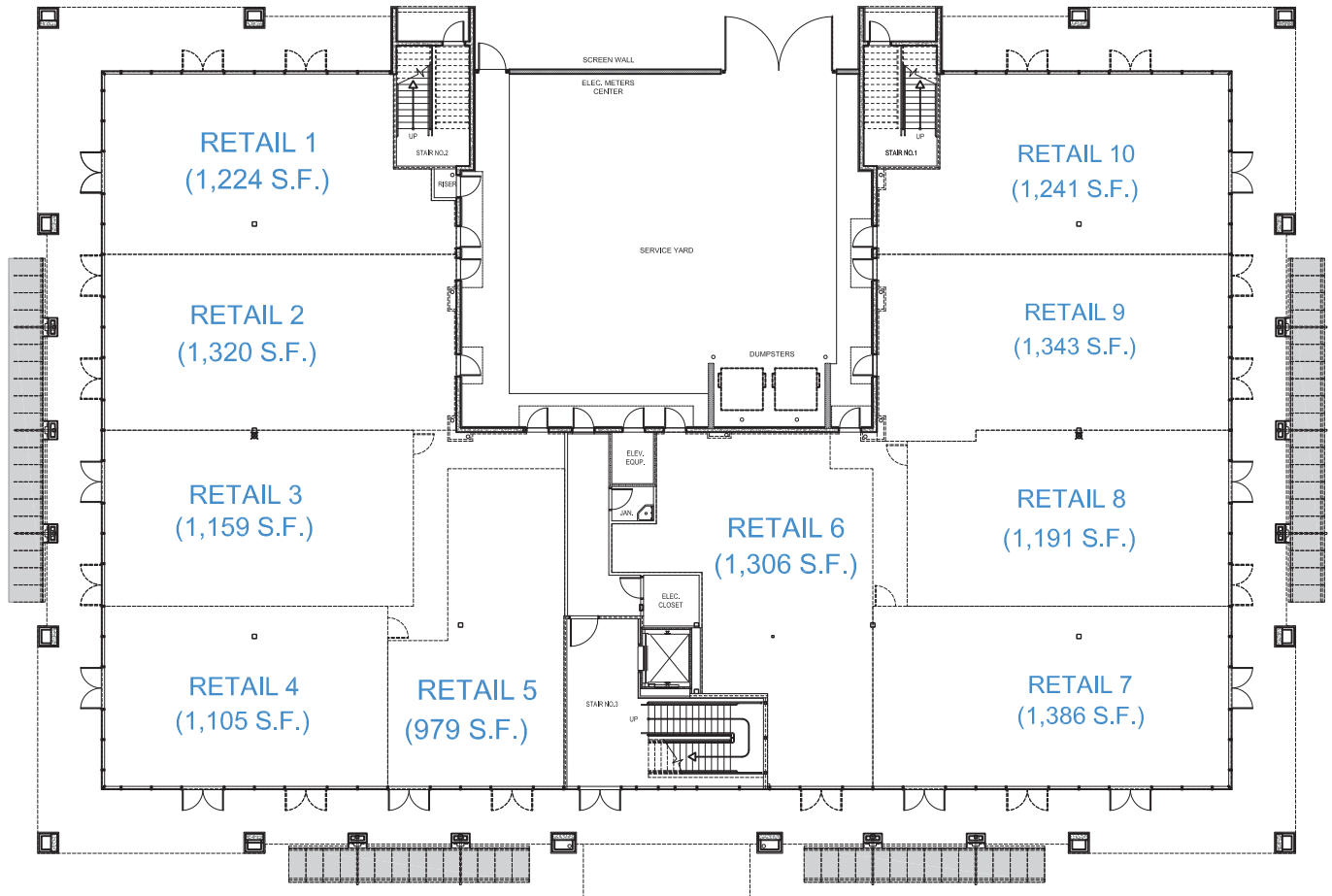

2ND FLOOR

The Point at Gate Parkway | 7720 Baymeadows Rd E | Jacksonville, FL 32256

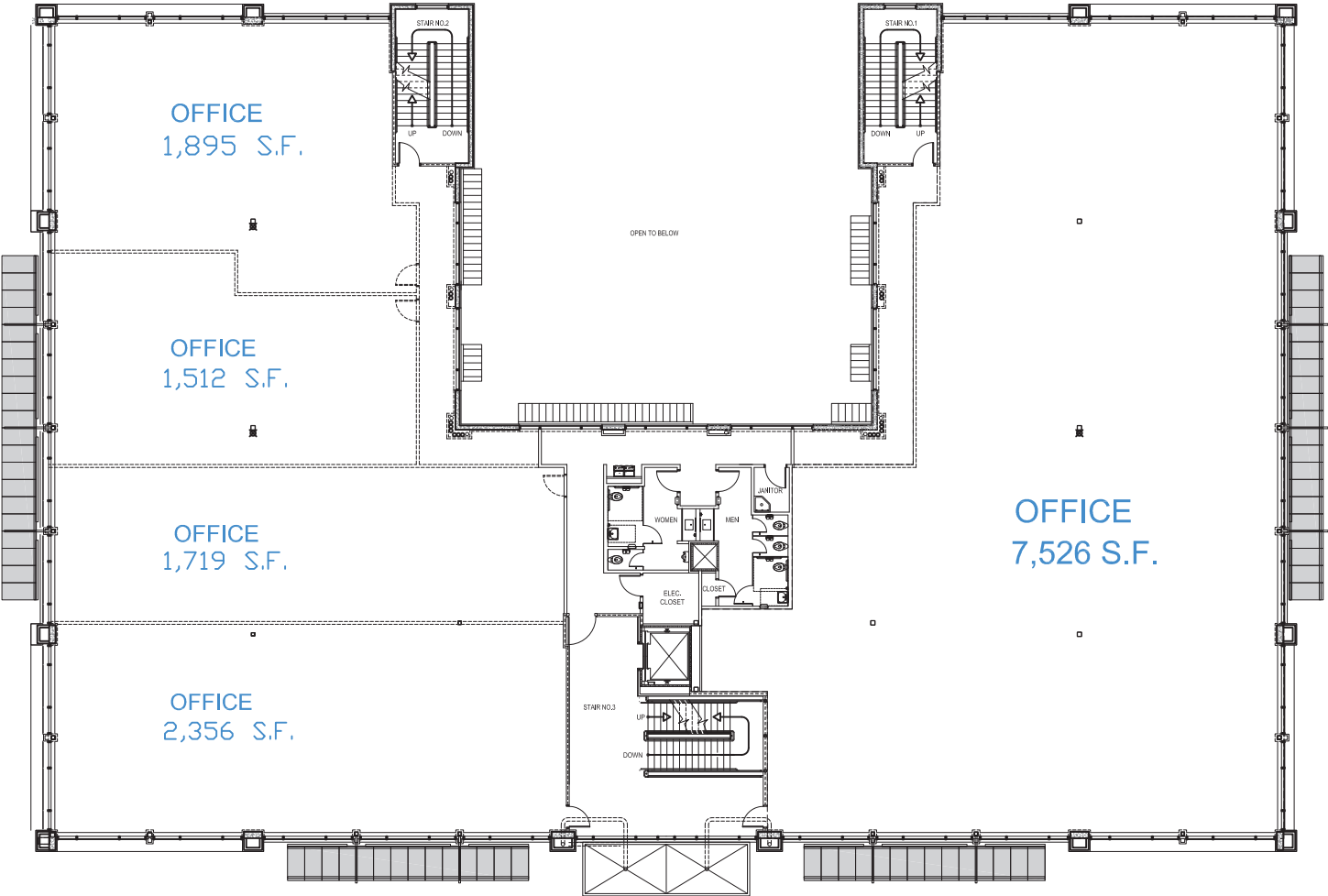

3RD FLOOR

The Point at Gate Parkway | 7720 Baymeadows Rd E | Jacksonville, FL 32256

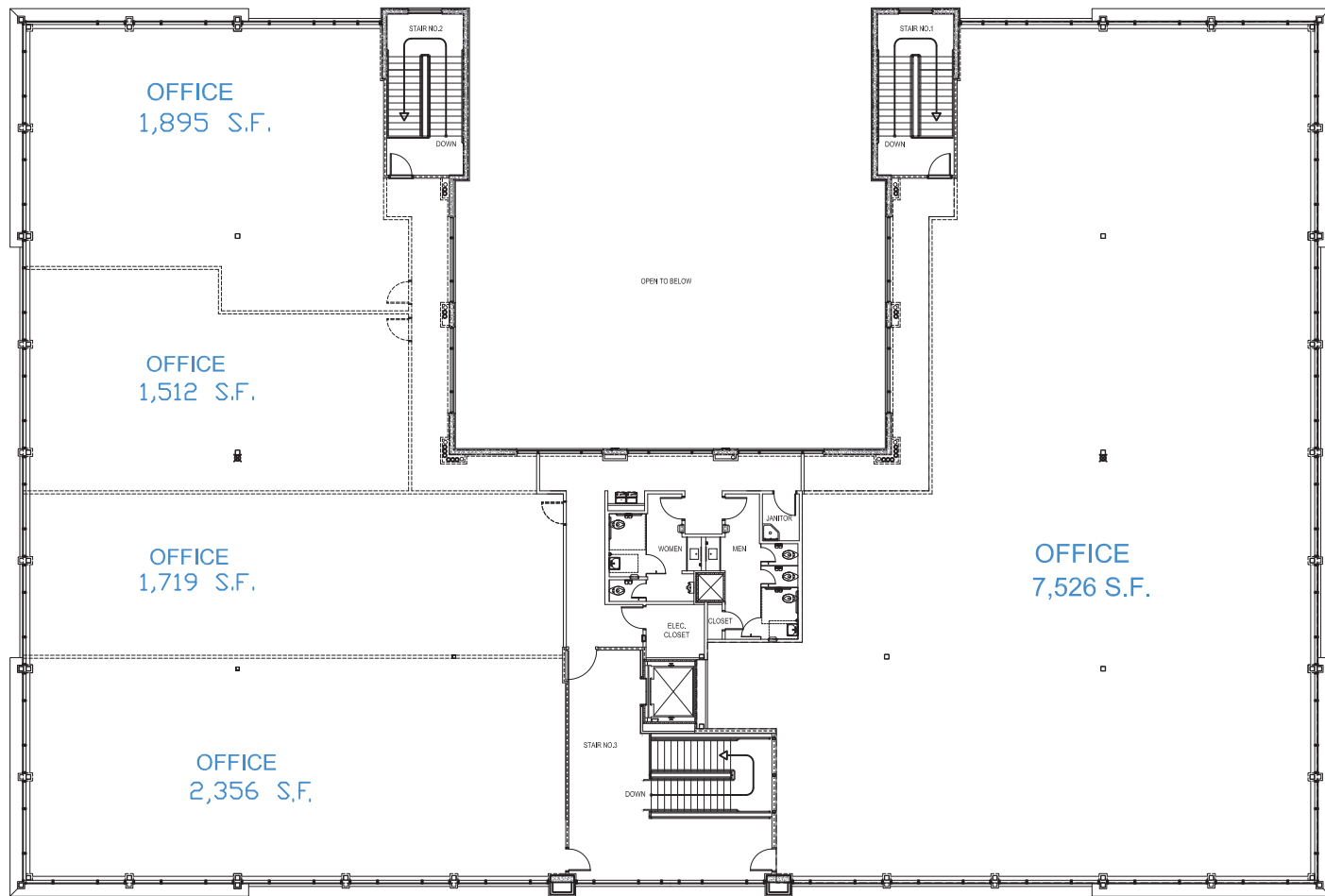

FOR MORE INFO



ashproperties.com



leasing@ashproperties.com



904.992.9000