

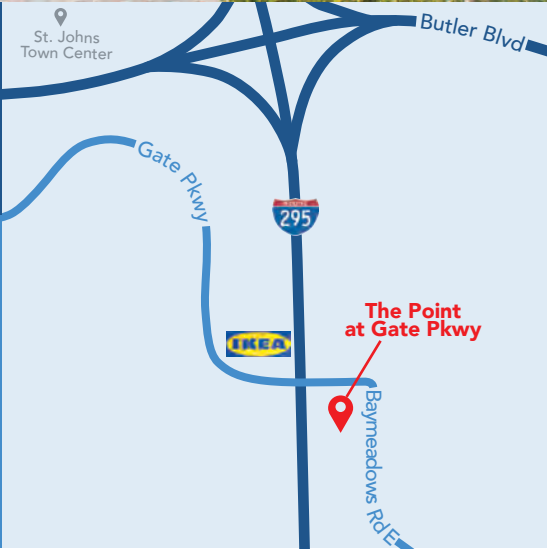

THE POINT at GATE PKWY

7720 Baymeadows Rd E | Jacksonville, FL 32256



Strategically positioned in the heart of Jacksonville’s booming Southside market

Top two floors present a variety of office spaces fit for modern professionals

Ground floor units ideal for retail shopping

SIZE

Building Size
54,354 sq ft±

Divisible Space
Retail: **1,000-7,500**
sq ft±
Office: **2,000-30,000**
sq ft±

DEMOGRAPHICS

	Population	Total Households	Average HH Income
1 Mi	3,898	1,693	\$130,891
3 Mi	43,494	18,109	\$112,379
5 Mi	129,901	55,546	\$109,070

TRAFFIC

Baymeadows Rd
15,300
I-295/SR-9A
105,000

PHOTOS

The Point at Gate Parkway | 7720 Baymeadows Rd E | Jacksonville, FL 32256



1ST FLOOR

The Point at Gate Parkway | 7720 Baymeadows Rd E | Jacksonville, FL 32256

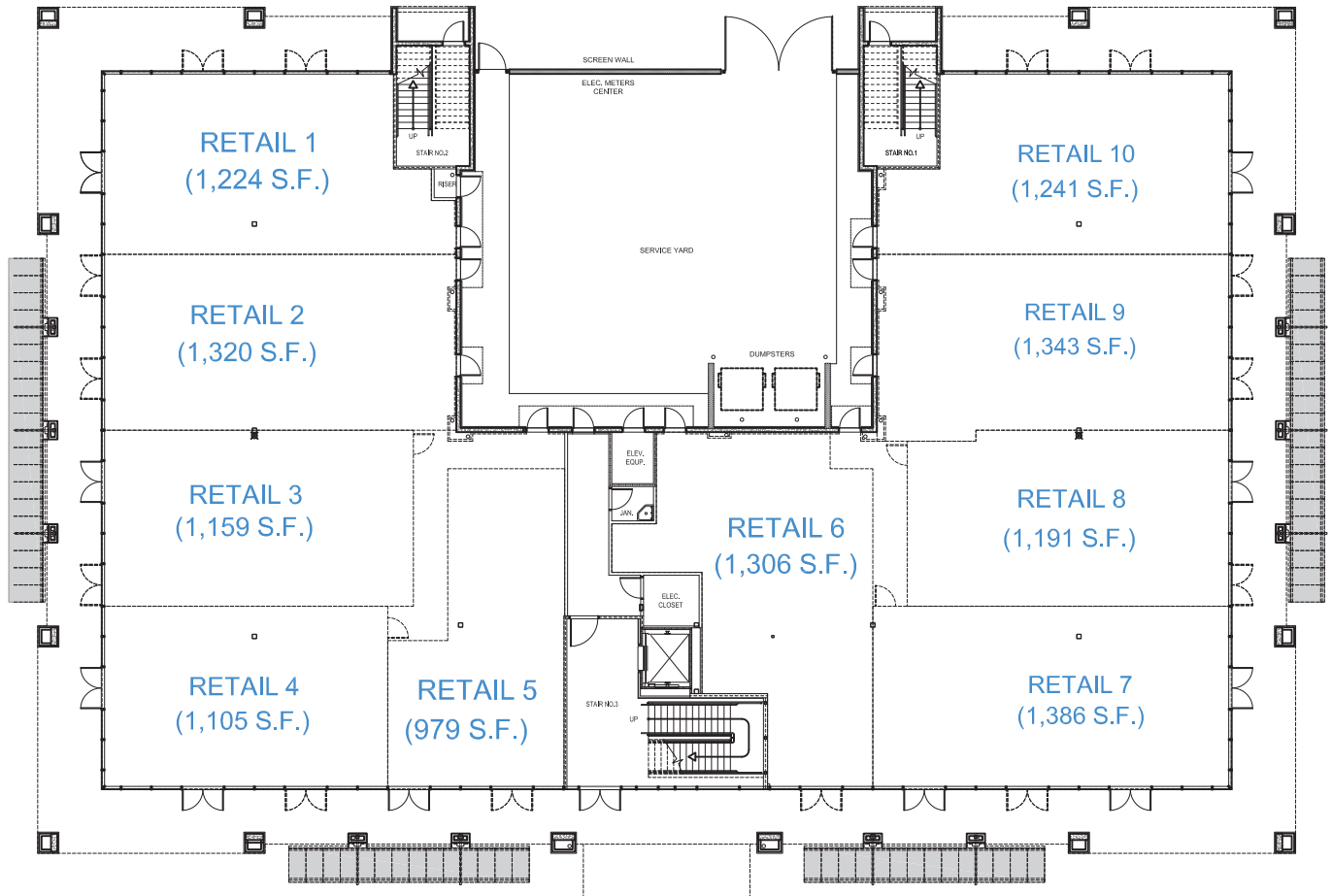

2ND FLOOR

The Point at Gate Parkway | 7720 Baymeadows Rd E | Jacksonville, FL 32256

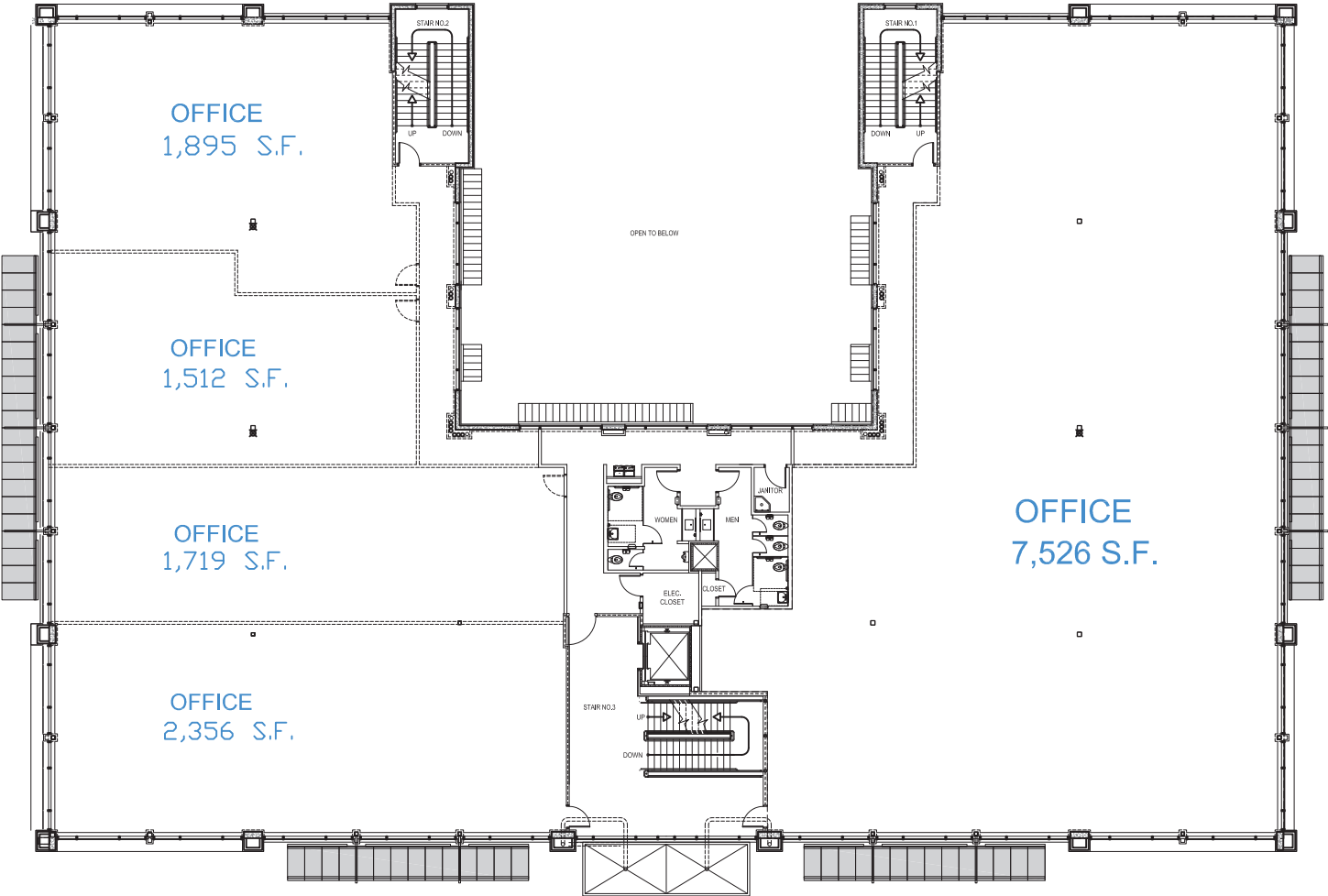

3RD FLOOR

The Point at Gate Parkway | 7720 Baymeadows Rd E | Jacksonville, FL 32256

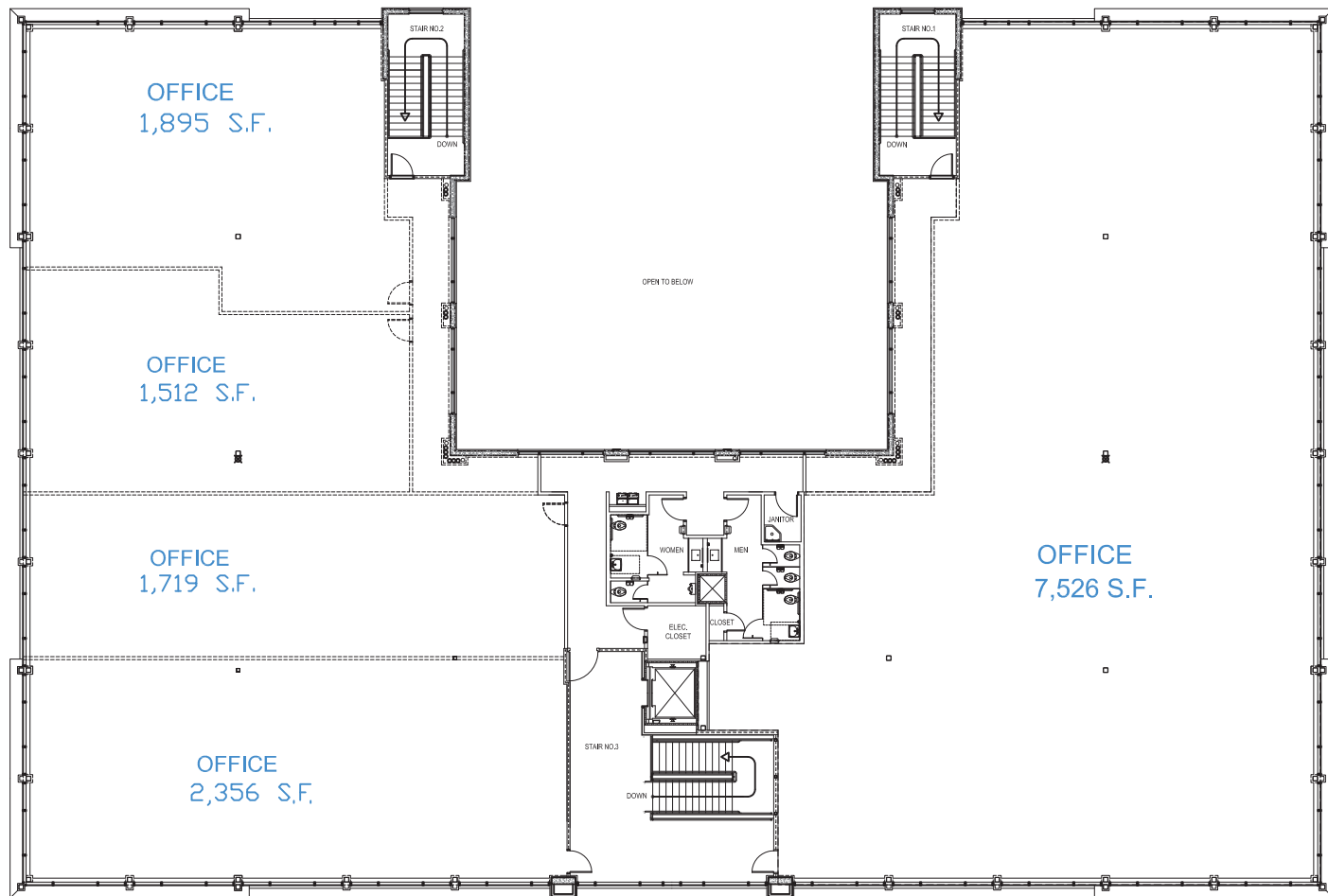

FOR MORE INFO  [ashproperties.com](https://www.ashproperties.com)  leasing@ashproperties.com  904.992.9000